

RET-A .. /..

THRESHOLD & RUNWAY END LIGHT

HIGH INTENSITY - BIDIRECTIONAL-INSET

RELATED STANDARDS

FAA : RET-A is in accordance with FAA specifications AC-150/5345-46B L-850E and L-850D

ICAO : RET-A is in accordance with Annex 14, Vol.1, Appendix 2, to be used as threshold and runway edge light in CAT I, II & III conditions

NATO : RET-A is in accordance with STANAG 3316

APPLICATIONS

➤As high intensity, threshold and edge lighting for runways in CAT I, II & III conditions

IMPORTANT FEATURES

➤**High mechanical strength** obtained by cadmium plated iron, helps resist all kind of aircraft loads.

➤**Optical system** simple and watertight.

➤**Prefocused halogen lamp** is very advantageous compared to other alternatives with 1000 hours of lamp life and PK30d lamp base.



FIGURE 1

ELECTRICAL SUPPLY

6,6A through 1 or 2 isolating transformers.

FINISH

Cadmium plated against corrosion. Lower cover is aluminium cast and anodized.

CONSTRUCTION

1. Stainless steel screw with washer
2. Cover and prism
3. Color filters
4. Filter holder
5. Silicone rubber gasket
6. Optical system
7. Silicone rubber gasket
8. Lower cover
9. Pressure relief plug
10. Mounting base
11. Stainless steel screw with washer
12. Lower cover connecting screws
13. Lamp, quartz halogen, prefocused PK30d

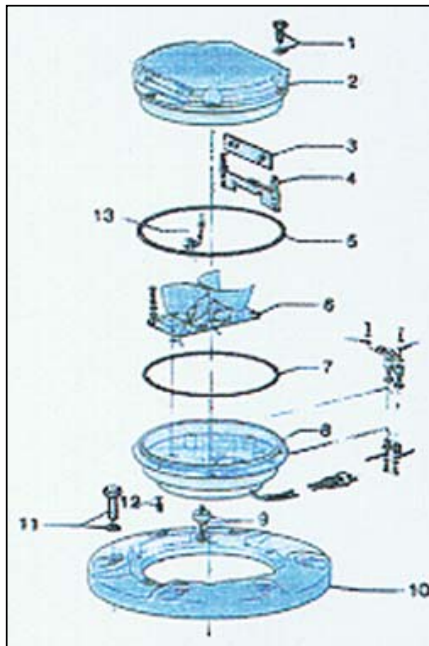

FIGURE 2



FIGURE 3

WEIGHT AND DIMENSIONS

Gross weight is 15kg.
25mm height from ground level
Outer diameter is 438mm.

PACKING INFO

In cardboard boxes of 32×32×18cm.

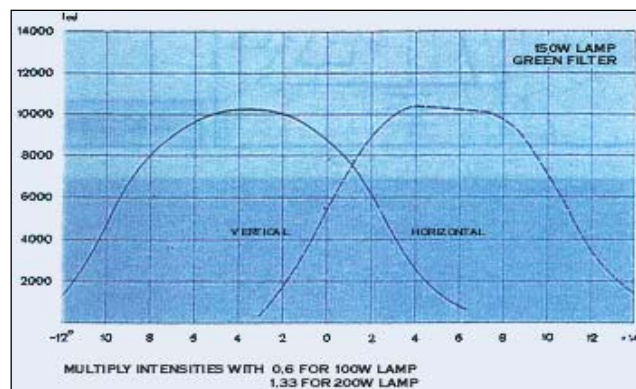

OPTICAL PERFORMANCE